



この図面等は、土地区画整理事業に関する参考資料として提供しています。  
 ○図面等は換地処分時のものであり、現在の状況とは異なる場合があります。  
 ○図面等によって、境界等が確定されるものではありません。

12/B  
 トラバ-精度 1/1000

$\text{No.100 } x = 42.67, y = 66.071$   
 $\text{Sec } 5^{\circ}17' (1.0043) \times 25.00 = 25.11$   
 $\text{Tan } 5^{\circ}17' (0.0925) \times 18.00 = 23.44$   
 $1.67(-)$   
 $23.44$   
 $52.61$

$\text{Tan } 6^{\circ}10' (0.1080) \times 18.00 = 1.94$   
 $\text{Tan } 0^{\circ}06' (0.0017) \times 18.00 = 0.03$   
 $\text{No.101 } x = 4.317, y = 48.379$   
 $\text{No.102 } x = 4.323, y = 44.183$   
 $167^{\circ}40'44''$   
 $179^{\circ}48'04''$

$\text{Sec } 1^{\circ}29' (1.0003) \times 10.00 = 10.00$   
 $\text{Tan } 1^{\circ}29' (0.0257) \times 18.00 = 0.47(-)$   
 $9.53$   
 $\text{No.16 } x = 44.15, y = 13.376$

$\text{Sec } 5^{\circ}17' (1.0043) \times 18.00 = 18.08$   
 $\text{Tan } 5^{\circ}17' (0.0925) \times 25.00 = 23.1(-)$   
 $15.77$

$50M$   
 $88.91$

$\text{Sec } 6^{\circ}02' (1.0056) \times 4.00 = 4.02$   
 $\text{Tan } 6^{\circ}02' (0.1057) \times 25.00 = 2.64$   
 $1.35$

$\text{No.140 } x = 4.230, y = 14.556$

$\text{Sec } 6^{\circ}02' (1.0056) \times 25.00 = 25.14$   
 $\text{Tan } 6^{\circ}02' (0.1057) \times 4.00 = 0.42(-)$   
 $24.72$

$\text{Sec } 0^{\circ}16' (1.0000) \times 10.00 = 10.00$   
 $\text{Tan } 0^{\circ}16' (0.0047) \times 4.00 = 0.02(+)$   
 $10.02$   
 $\text{No.17 } x = 43.66, y = 96.157$

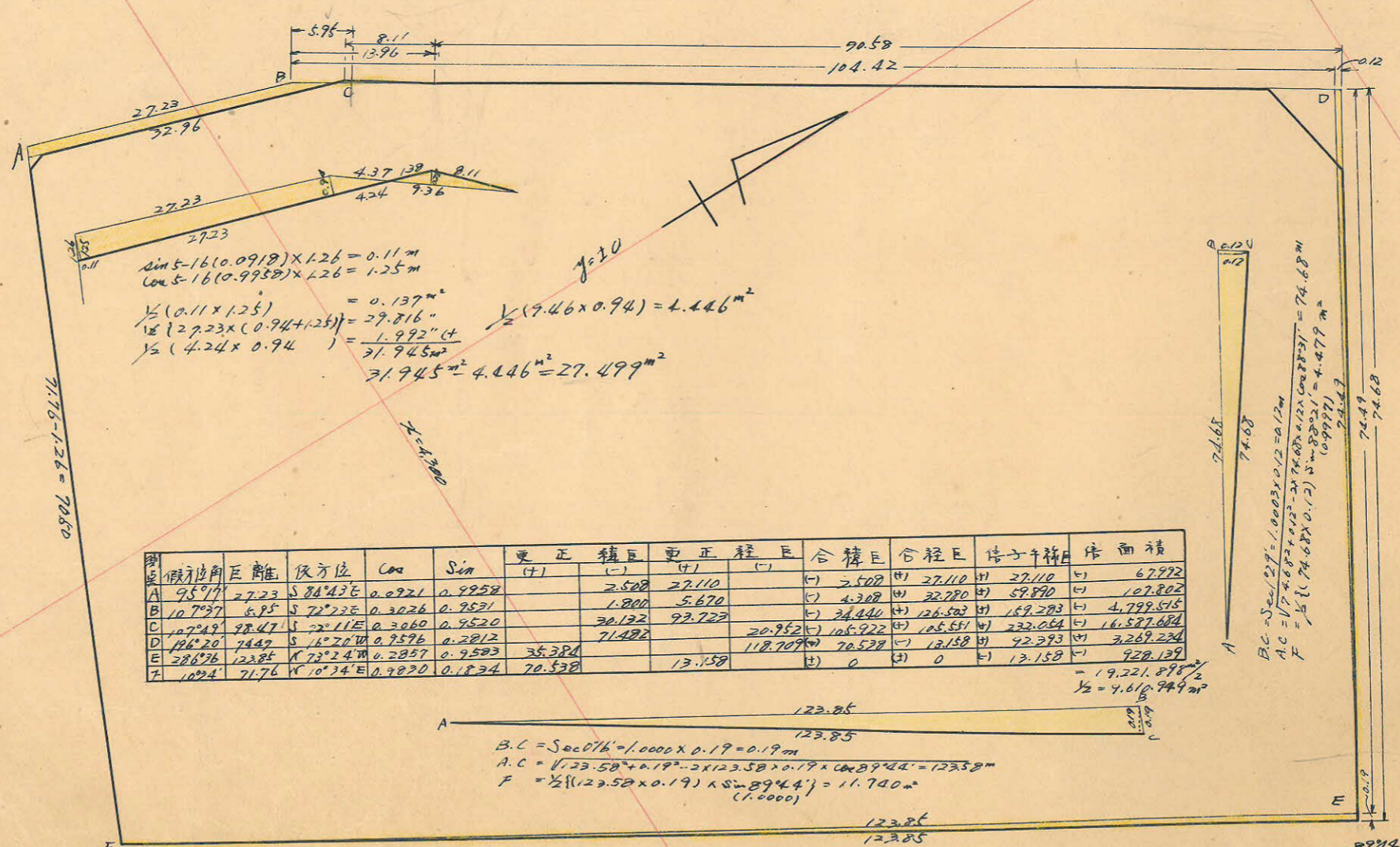

順	假方位角	距離	仮方位	Cos	Sin	更正積距 (+)	更正積距 (-)	合積距 (+)	合積距 (-)	倍子積距 (+)	倍子積距 (-)	体面積
A	95°17'	27.23	S 84°43' E	0.0921	0.9958	2.508	27.110	(-) 2.508	(+) 27.110	(+) 27.110	(-) 27.110	67.992
B	107°37'	6.85	S 72°25' E	0.3026	0.9531	1.800	5.670	(-) 1.800	(+) 5.670	(+) 32.780	(+) 59.890	107.802
C	107°49'	88.47	S 72°11' E	0.3060	0.9520	30.122	92.722	(-) 34.440	(+) 126.582	(+) 159.293	(-) 4,799.515	4,799.515
D	126°20'	74.47	S 16°20' W	0.9596	0.2812	71.422	20.952	(-) 20.952	(+) 105.922	(+) 106.551	(+) 232.064	16,587.684
E	286°26'	122.85	N 72°24' W	0.2857	0.9593	35.384	118.707	(+) 118.707	(-) 70.538	(-) 13.158	(+) 92.393	3,269.234
F	102°4'	71.76	N 10°34' E	0.9820	0.1834	70.538	13.158	(-) 13.158	(+) 0	(-) 0	(-) 13.158	928.139

$B.C = \text{Sec } 0^{\circ}16' = 1.0000 \times 0.19 = 0.19$   
 $A.C = \sqrt{123.50^2 + 0.19^2} = 123.50$   
 $F = \frac{1}{2} \{ (123.50 \times 0.19) \times \sin 89^{\circ}44' \} = 11.740$

合計面積 =  $9610.947 + 11.740 + 4.479 - 27.499 = 9599.667 = (x 0.3025 - 2.903.89) = 2.903.85$   
 剪除面積 =  $0.90 + 31.90 = 32.80 = (x 0.3025 = 9.92) = 9.91$   
 割込面積 =  $9.566.86 = (x 0.3025 = 2.893.97) = 2.893.94$

$\text{Sec } 2^{\circ}19' (1.0002) \times 18.00 = 18.01$   
 $\text{Tan } 2^{\circ}19' (0.0258) \times 10.00 = 0.26$   
 $17.75$

$\text{Sec } 0^{\circ}16' (1.0000) \times 4.00 = 4.00$   
 $\text{Tan } 0^{\circ}16' (0.0047) \times 0.06 = 0.0003$

$\gamma = 100$